

GUNNING



Suite 403/88 Foveaux Street Surry Hills NSW

88 Foveaux Street, Surry Hills is located approximately 450 meters from Central Station. The building has been completely refurbished and is serviced by 2 high speed elevators. Easy access to public transport (Central Bus and Train Stations), restaurants and cafes.

OFFICE FEATURES:

- 35sqm on Level 4
- 2 partitioned office or consulting room
- Reception area
- Long windows with beautiful leafy outlook
- Views to Foveaux Street & great natural light
- Shared Kitchenette and Toilets on each level

For further information or to inspect, please contact the agent.

Building Size : 35 sqm
Land Size : 35 sqm
View : <https://www.gunningre.com.au/lease/nsw/eastern-suburbs/surry-hills/commercial/offices/7667721>



Tushar Bakshi
02 9698 0222

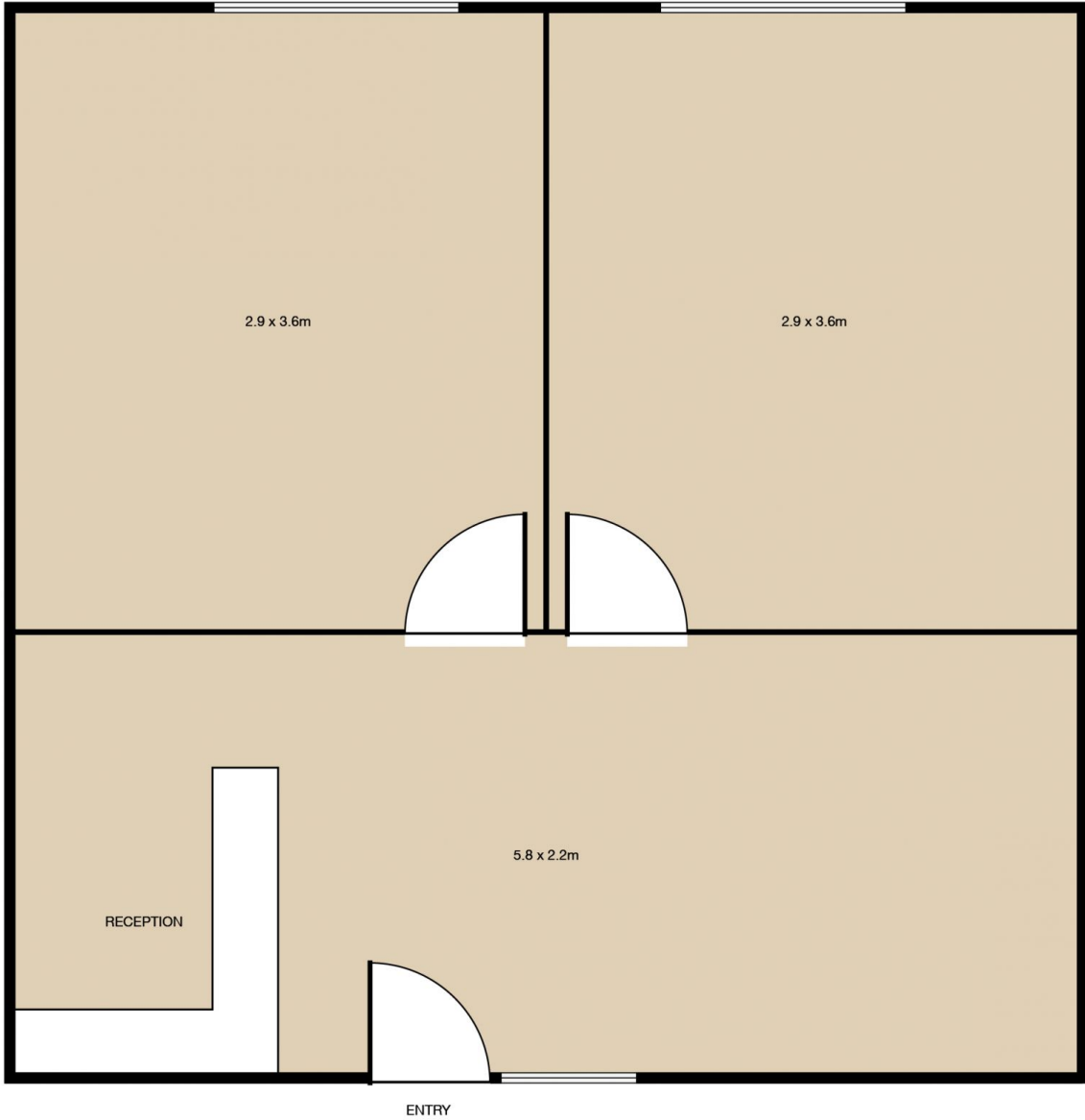

Suite 403/88 Foveaux Street, SURRY HILLS



Total Area : 34m²

This floor plan is intended as a guide only. Layout dimensions are approximate only. No representations or warranties of any nature whatsoever are given or intended. Any person using this information should rely on their own enquiries. Floor plans by Josef Geranio Studio, info@josefgeranio.com

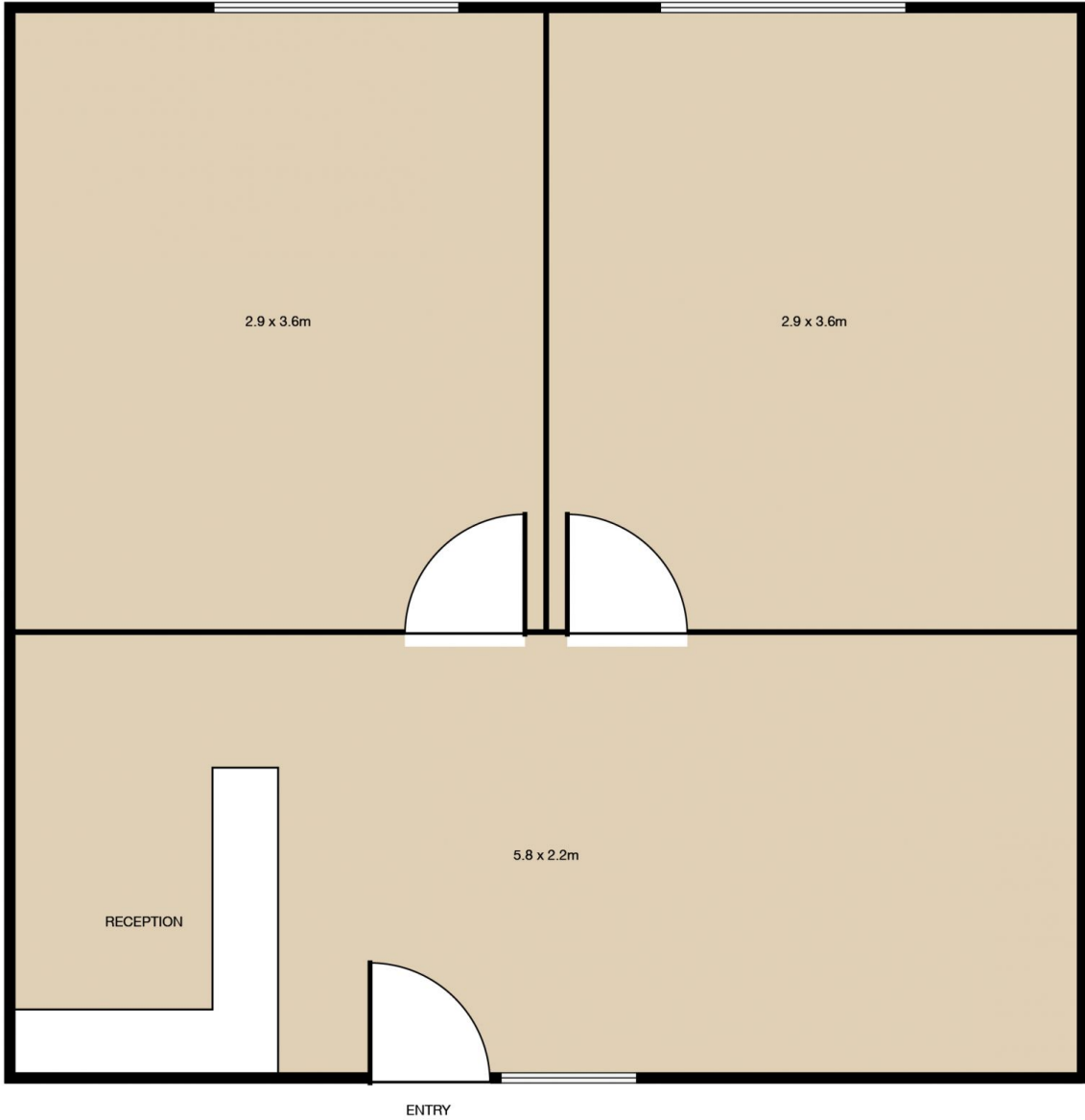

Suite 403/88 Foveaux Street, SURRY HILLS



Total Area : 34m²

This floor plan is intended as a guide only. Layout dimensions are approximate only. No representations or warranties of any nature whatsoever are given or intended. Any person using this information should rely on their own enquiries. Floor plans by Josef Geranio Studio, info@josefgeranio.com